

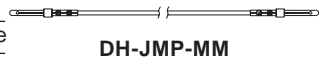

MISCELLANEOUS HARDWARES

RS 232 PIN JUMPERS

DH-JMP-MM	Male to Male
DH-JMP-FF	Female to Female
DH-JMP-MT	Male to Tined
DH-JMP-FT	Female to Tined
DH-JMP-MF	Male to Female
DH-JMP-YMM	Y-Jumper, M-M-M
DH-JMP-YFF	Y-Jumper, F-F-F
DH-JMP-YFMM	Y-Jumper, F to M-M
DH-JMP-YMFF	Y-Jumper, M to F-F



DH-JMP-MM

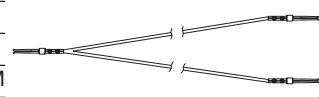

DH-JMP-YFF

MISCELLANEOUS

H-JMPLED	Jumper Load Wire 26 awg, 2", 50/ bag
H-CSR09/S	Metal Cord Strain Relief
H-CSR25/S	Set for DB9 hoods, 100/Bag
MD-MTLCH	Mini Din Strain Relief Metal Latch, 100/Bag

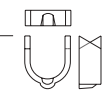
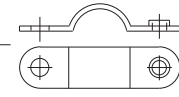

THUMB SCREWS

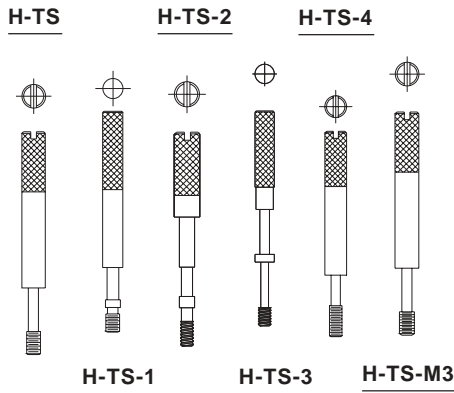

H-TS	4/40 Thread, good for
H-TS-1	D-Sub Hood
H-TS-2	4/40 Thread for molded hood
H-TS-3	4/40 Thread for DDN hood use
H-TS-4	4/40 Thread, 2.245" Long.
H-TS-M3	M3 Matric Thread

HARDWARE FOR HOODS



H-SET-25C/S

H-SET-25C Includes one set cord strain reliver wire holder, Saddle Washer, Shoulder Screw, 12mm 4/40 screw, 7.5mm 4/40 screw and nut. For DP25C

H-SET-25C/S Includes two each Saddle Washer, Shoulder screw, 12mm 4/40 screw, nut, and one plastic strain relief screw. For DP-25C/S

SCREW LOCK KIT

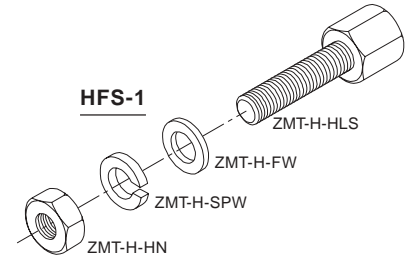

HFS-1

HFS-1 Include 1 short 4/40 Hex Locking Screw thread length 7.5mm, and 2 Flat washer, 1 split washer, and 1 nut.

HFS-1/SET Include 2 short 4/40 Hex Locking Screw thread length 7.5mm, and 4 Flat washer, 2 split washer, and 2 nut.

HFS-2 Include 1 Hex Locking Screw thread length 12 mm, and 2 Flat washer, 1 split washer, and 1 nut.

HFS-2/SET Include two 4/40 Hex Locking Screw thread length 12 mm, and 4 Flat washer, 2 split washer, and 2 nut.

HFS-3/SET Include 2 each Hex Locking Screw thread length 7.5mm, 4 Flat washer, 2 split washer, and 2 nut.

CAPTIVE SCREW & RETAINING CLIP

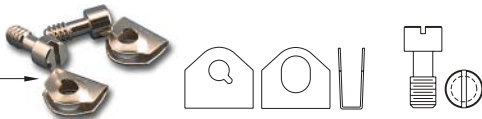

HRC-1	Include retaining Clip and Captive screw.
HRC-1/SET	Include 2 retaining Clip and 2 Captive Screw.

ZMT-H-CS	4/40 Captive screw
ZMT-H-FW	Flat washer for #4 screw
ZMT-H-HLS 7.92	4/40 Hex locking screw 7.92mm thread
ZMT-H-HLS 10.9	4/40 Hex locking screw 10.9mm thread
ZMT-H-HLS 14.22	4/40 Hex locking screw 14.22mm thread
ZMT-H-HN	4/40 Hex nut
ZMT-H-RC	Retaining clip for #4 screw
ZMT-H-S	4/40 screw for H-SET-9C, 25C, 25C/S
ZMT-H-SAW	Saddle washer
ZMT-H-SPW	Split washer for #4 screw
ZMT-H-SS	4/40 Shoulder screw. Half Threaded
ZMT-HTS-ADM25-L-GR	4/40 Shoulder screw for ADM-25

BAIL LOCK & BARREL NUTS

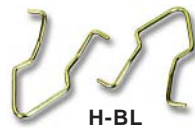

H-BL

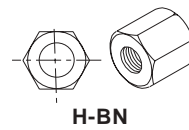

H-BN

H-BL	Bail Locks for Centronic Connector
H-BN	4/40 Barrel nuts
H-BN1	4/40, 8mm.

FOR AUI CABLE

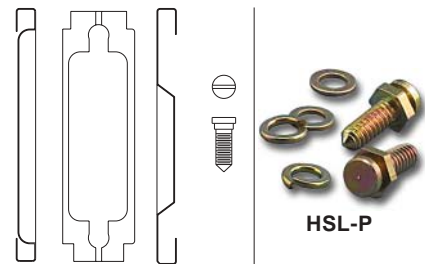

HSL-15	Slide Latch
HSL-P	Slide Lock Post Kit, Include 2 each Locking Post and 2 flat washers, 2 split washer